

Where  
Life is a  
Vacation.





Actual Photograph

# the resort

by

# bptp

culture } movement

After a long day at the grind, when your briefcase feels a bit too heavy and the drive back home seems to take forever, what you need is a vacation. So, we decided to give you one at the Resort - our high-rise apartment community in Parklands. Apart from offering you the finest amenities and world-class living standards, the property assures you of complete peace and calm. As the 1st Phase of the project comprises of just 6 towers spread over 10.92 acres in Sector 75, Faridabad, you get to enjoy the benefits of a low density living. And when the office beckons, you'll get there in no time on the proposed six-lane bridge\* over the Agra-Gurgaon canal, that also provides you with convenient access to every part of Faridabad.



Laminated wooden flooring in bedrooms



Air-conditioned bedrooms



Wardrobes in bedrooms



Recreational club with swimming pool



Half modular kitchen



Proposed 6-lane bridge in close proximity





## Pamper Yourself In Serenity

Some days are just meant  
to laze by the pool, enjoy a great meal,  
unwind with a relaxing massage.

Those days were made for  
the Sanctuary, our exclusive club  
at the Resort.



SANCTUARY



## Celebrate Your Oasis

There are some places which make anything better. They bring the spark back to your life. And the next time you come home, you'll find such a place in the exquisitely landscaped greens of the Resort.

Render of the actual design



SANCTUARY



PROPOSED METRO LINE  
(CONSTRUCTION IN PROGRESS)

TOWARDS FARIDABAD-GURGAON HIGHWAY

BADARPUR

PROPOSED DEVELOPMENT

NH-2

GT ROAD - DELHI TO AGRA HIGHWAY

NH-2

NH-2

FROM DELHI

TO PALWAL

the resort  
by  
**oobo**  
culture } movement



Location Plan

PROPOSED EXPRESS HIGHWAY

FROM DELHI

**FARIDABAD**

FROM NOIDA

NOT TO SCALE

45 M WIDE SECTOR ROAD TO BRIDGE



Site Plan



NOT TO SCALE

30 M WIDE SECTOR ROAD

AREA: 131.92 - 132.75 Sq. Mtrs. (1420 - 1429 Sq. Ft.)  
2 BHK + 2 TOILETS



AREA: 137.12 Sq. Mtrs. (1476 Sq. Ft.)  
2 BHK + 2 TOILETS



AREA: 152.63 - 153.38 Sq. Mtrs. (1643 - 1651 Sq. Ft.)  
3 BHK + 2 TOILETS

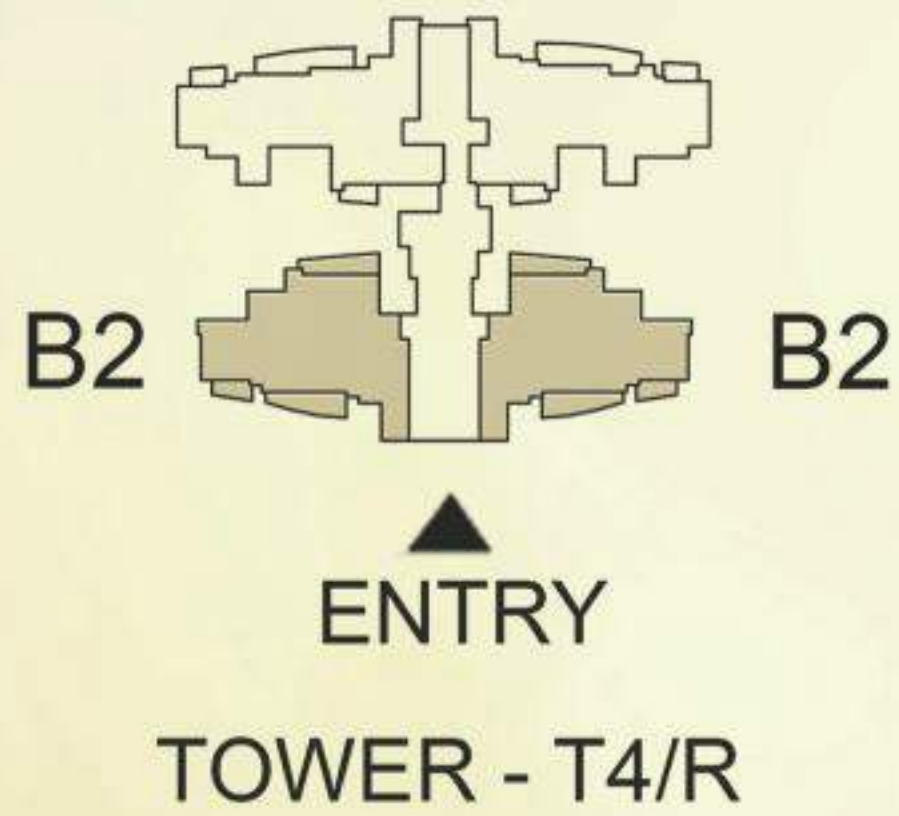

AREA: 154.77 - 158.39 Sq. Mtrs. (1666 - 1705 Sq. Ft.)  
3 BHK + 2 TOILETS



AREA: 158.02 - 160.44 Sq. Mtrs. (1701 - 1727 Sq. Ft.)  
3 BHK + 2 TOILETS

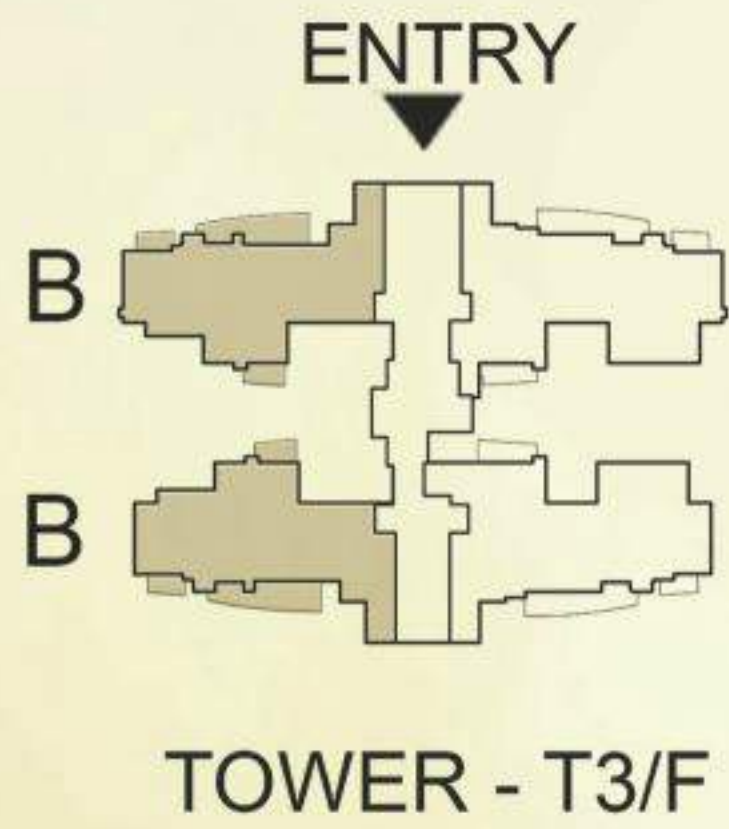

TOWER - T3/F

AREA: 176.79 - 177.07 Sq. Mtrs. (1903 - 1906 Sq. Ft.)  
3 BHK + 3 TOILETS + SERVANT

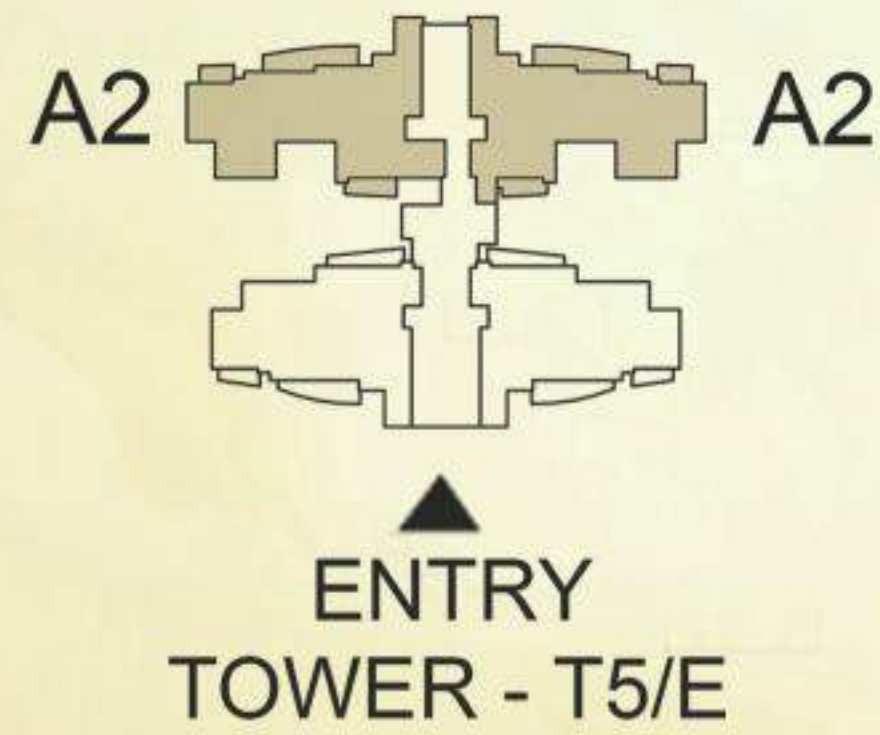

AREA: 176.79 Sq. Mtrs. (1903 Sq. Ft.)  
3 BHK + 3 TOILETS + SERVANT

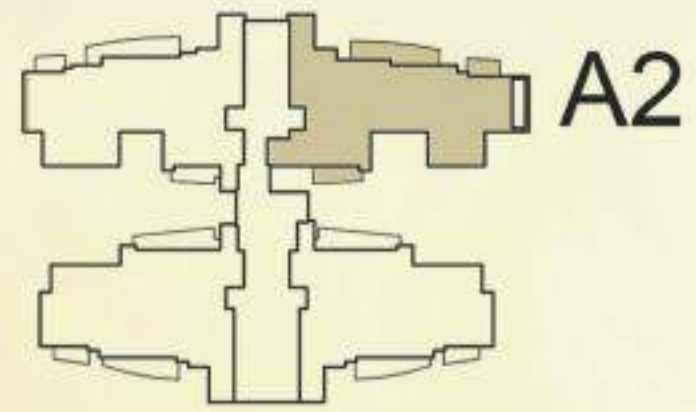

ENTRY  
TOWER - T6/A

AREA: 177.25 - 177.35 Sq. Mtrs. (1908 - 1909 Sq. Ft.)  
3 BHK + 3 TOILETS + SERVANT

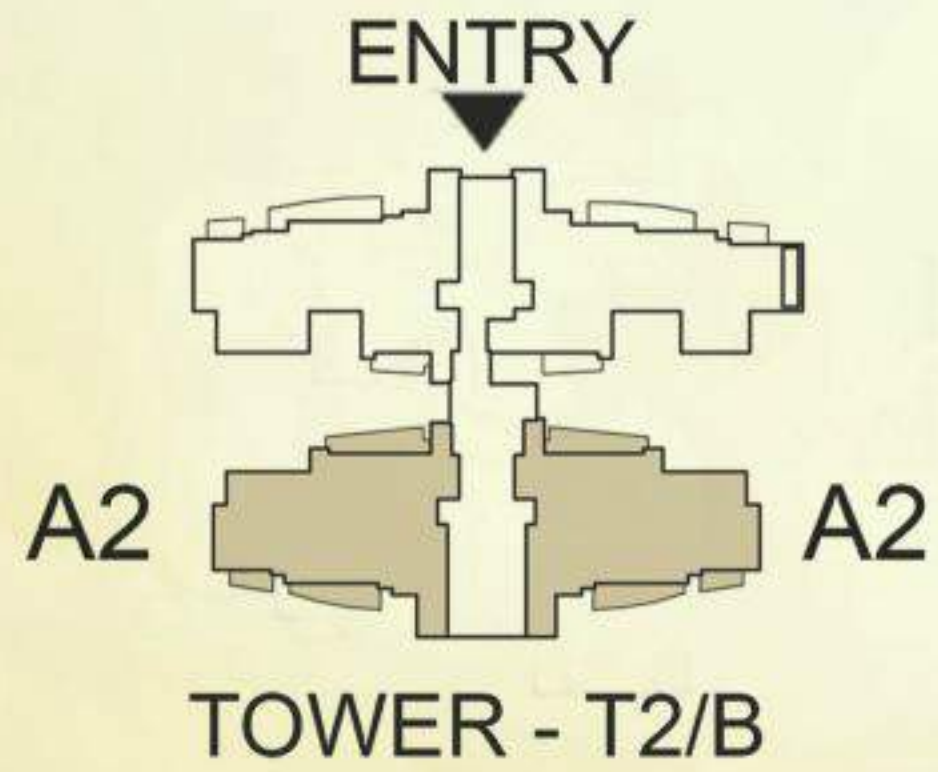

AREA: 177.72 - 179.02 Sq. Mtrs. (1913 - 1927 Sq. Ft.)  
3 BHK + 3 TOILETS + UTILITY

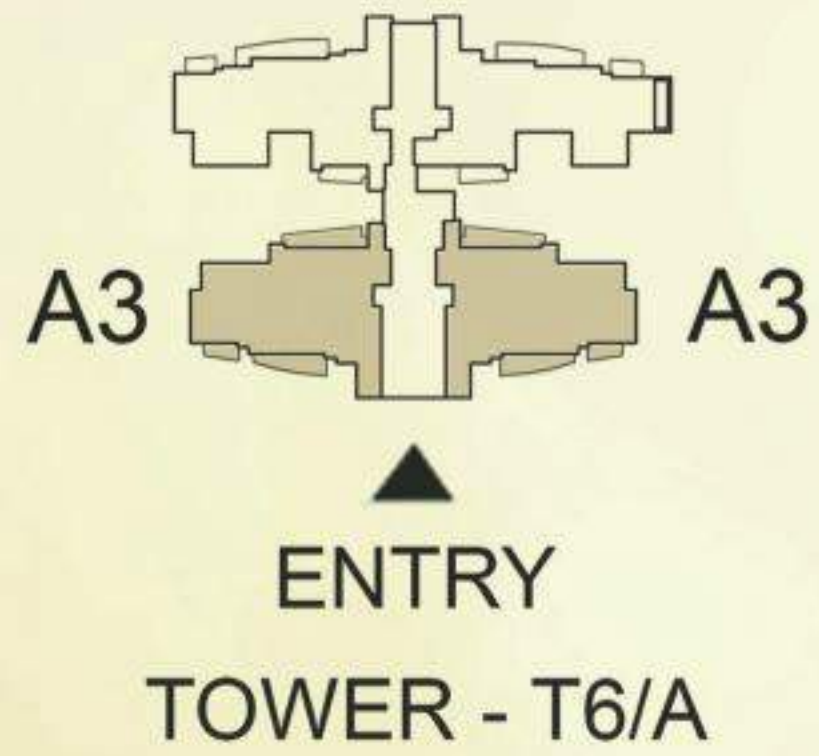

AREA: 187.57 Sq. Mtrs. (2019 Sq. Ft.)  
3 BHK + 3 TOILETS + SERVANT

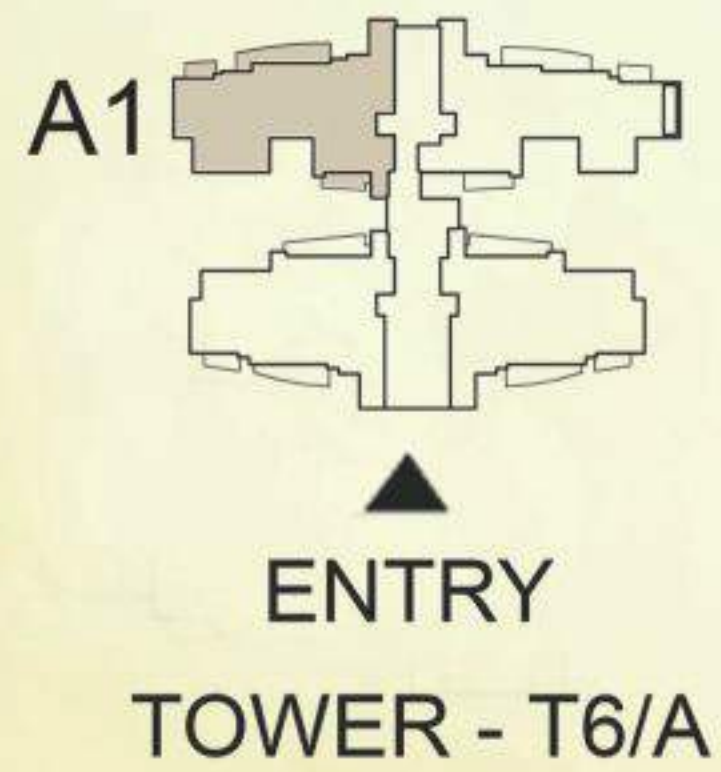

AREA: 187.84 - 190.63 Sq. Mtrs. (2022 - 2052 Sq. Ft.)  
3 BHK + 3 TOILETS + SERVANT

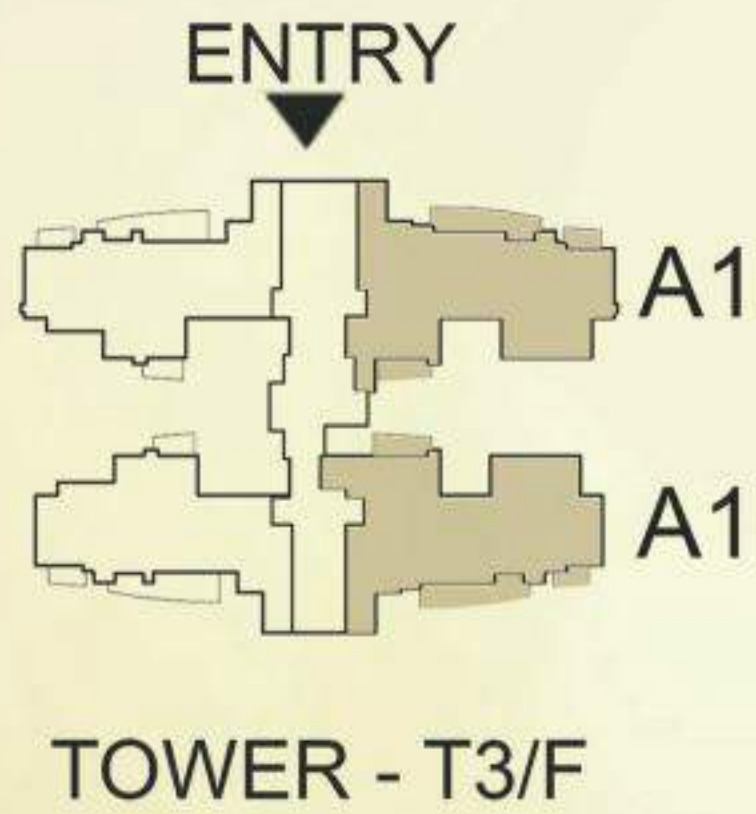

AREA: 164.06 - 164.15 Sq. Mtrs. (1766 - 1767 Sq. Ft.)  
3 BHK + 3 TOILETS

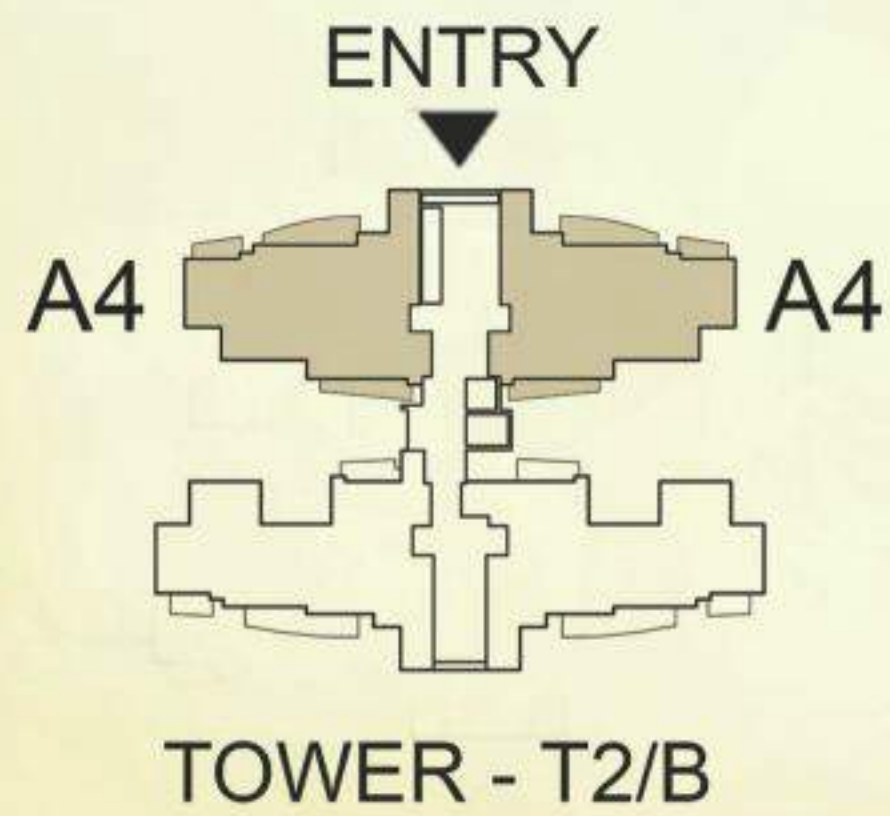

AREA: 164.43 Sq. Mtrs. (1770 Sq. Ft.)  
3 BHK + 3 TOILETS

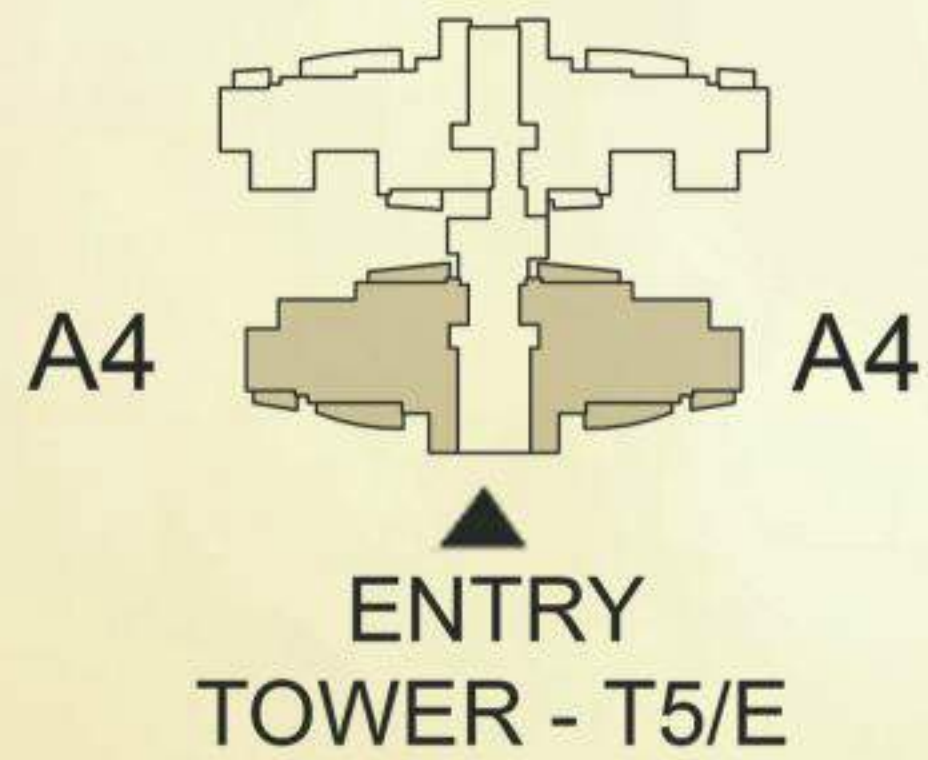



# Specifications



**LIVING/DINING**  
Wall Finish (Internal):  
Painted in pleasing  
shades of acrylic  
emulsion paint  
Flooring:  
Vitrified tiles with  
wooden skirting

---



**TOILETS**  
Fittings:  
Granite / marble counter,  
white sanitary fixtures,  
single lever CP fittings & geysers  
Dado :  
Selected ceramic tiles

---



**BEDROOMS**  
Wall Finish (Internal):  
Painted in pleasing  
shades of acrylic  
emulsion paint  
Flooring:  
Laminated wooden  
flooring  
Wardrobes in all bedrooms

---



**DOORS & WINDOWS**  
Windows:  
UPVC  
Doors:  
Seasoned hardwood  
frames with European  
style moulded shutters

---



#### HALF MODULAR KITCHEN

Flooring:  
Ceramic tiles  
Dado :  
Ceramic tiles above  
working platform,  
rest acrylic emulsion paint

---



#### BALCONY

Flooring:  
Anti-skid ceramic tiles

---



#### FACILITIES

Electrical Fittings:  
Conduit copper electrical  
wiring for all light &  
power points  
Air-Conditioning:  
Air-conditioners in all  
bedrooms. Provision of  
copper conduits and  
drainage pipes for  
split air-conditioning in  
living room  
100% power back-up &  
24X7 security

---



#### LIFT LOBBIES

Wall Finish:  
Select marble / Granite / Vitrified tiles  
Cladding & Acrylic emulsion paint

---



Park Grandeura

Actual Photograph



Chateau

Artistic Impression



BPTP Crest

Actual Photograph



The Deck

Artistic Impression



Capital City

Artistic Impression

# About BPTP

The last decade has witnessed the growth of BPTP, one of the most prolific real estate companies in the National Capital Region. Driven by the twin pillars of operational excellence and unparalleled customer experience, our endeavour is to create best in class and sustainable developments.

In just 9 years, we have successfully turned Faridabad into an incredibly promising real estate market, with our flagship project Parklands, a fully integrated township. In Gurgaon, we have created perfect examples of integrated luxury townships - Amstoria and Astaire Gardens and established a new genre of “Affordable Luxury” housing in NCR. While Capital City NOIDA, our marquee mixed use project is poised to set a bench mark in the Indian realty market.

Our core strengths are identifying opportunities before others, developing and successfully executing them. We have set our sights on a future which holds even greater promise as our company strives to achieve new heights.

the resort

by



culture } movement

BPTP Crest 15, Udyog Vihar, Phase IV, NH-8, Gurgaon-122015, Haryana, India.

Tel +91-9212288883, sales@bptp.com, www.bptp.com

DGTCP Haryana has granted M/s Countrywide Promoters (P) Ltd. license no. 1210 to 1261 dated 25/10/06 for development of group housing over 28.50 acres in Sector 75, Faridabad. The total no. of flats approved are 1691 (including EWS) in the building plan is approved vide memo no. 3619 on 14/02/08. There is a provision of 1 nursery school, 1 primary school & shopping area etc. However units located in Phase 1 measuring about 10 acres is being presently launched by the company. Architects and developers reserve the right to alter the specifications and facilities for design improvement. This communication is purely conceptual and not a legal offering. The developer reserves the right to amend/alter the area, layout, elevations, specifications and amenities. Elevation, photographs/images used in the brochure are purely artistic in nature and tend to change with/without prior notice.